

STOREFRONT PLAN & ELEVATION

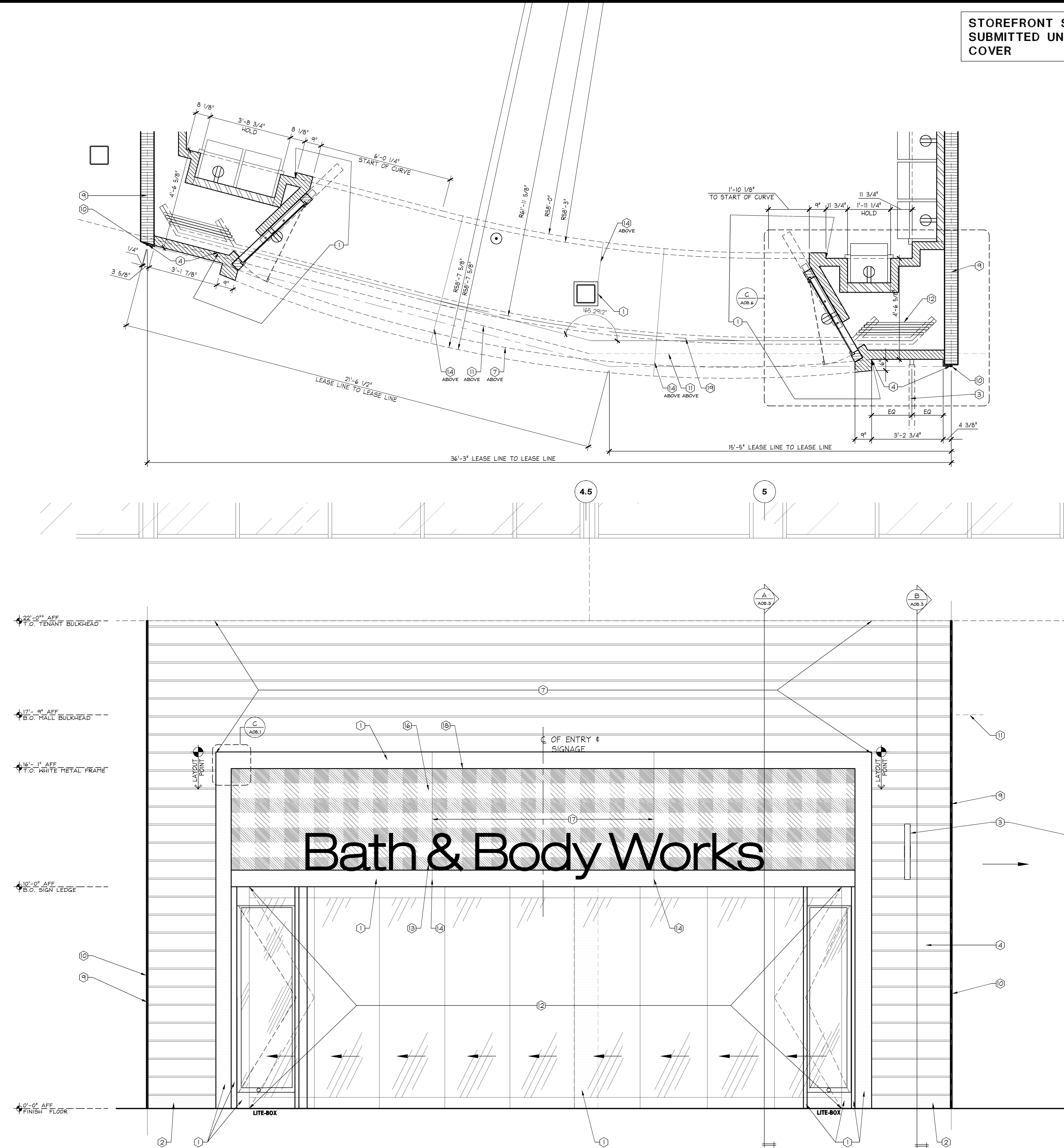

STOREFRONT SIGNAGE TO BE
SUBMITTED UNDER SEPARATE
COVER

- 1 PREFINISHED METAL PANEL **MT-2**
- 2 PREFINISHED METAL PANEL W/ INTEGRAL REVEAL **MT-3**
- 3 30" x 30" INTERNALLY ILLUMINATED BLADE SIGN.
- 4 SHIPLAP WOOD PLANKING **SF-2** - SEAMS RANDOMLY LOCATED (NO SEAMS TO ALIGN WITHIN 4 PLANKS)
- 5 NOT USED
- 6 NOT USED
- 7 CURVED SHIPLAP WOOD PLANKING **SF-2** - SEAMS RANDOMLY LOCATED (NO SEAMS TO ALIGN WITHIN 4 PLANKS)
- 8 NOT USED
- 9 LEASELINE
- 10 NEW NEUTRAL PIER PER MALL CRITERIA
- 11 (E) MALL BULKHEAD TO REMAIN. G.C. TO PATCH AND REPAIR AS REQ'D
- 12 1/2" TEMPERED SLIDING GLASS DOORS. SEE DOOR SCHEDULE FOR HARDWARE & SHOP DRAWINGS
- 13 20" HIGH WHITE FACE-LIT CHANNEL SIGNAGE WITH BLUE RETURNS
- 14 LINE OF METAL SEAM. FOR UNDERSIDE OF CANOPY, SEE C/A04.1
- 15 NOT USED
- 16 INTERNALLY ILLUMINATED LED GINGHAM TRANSOM - 1/2" STARFIRE GLAZING **G-7** OVER 1/2" POLYCARBONATE PANEL WITH PRE-ATTACHED FILMS **G-12**
- 17 G.C. TO SEAL GAPS W/ CLEAR SILICONE
- 18 GLAZING CHANNEL ALL SIDES
- 19 LINE OF SLIDING DOOR TRACK ABOVE

STOREFRONT PLAN & ELEVATION
KEYNOTES

FULL
42L-A083-D09-LEGD
D
06.30.09

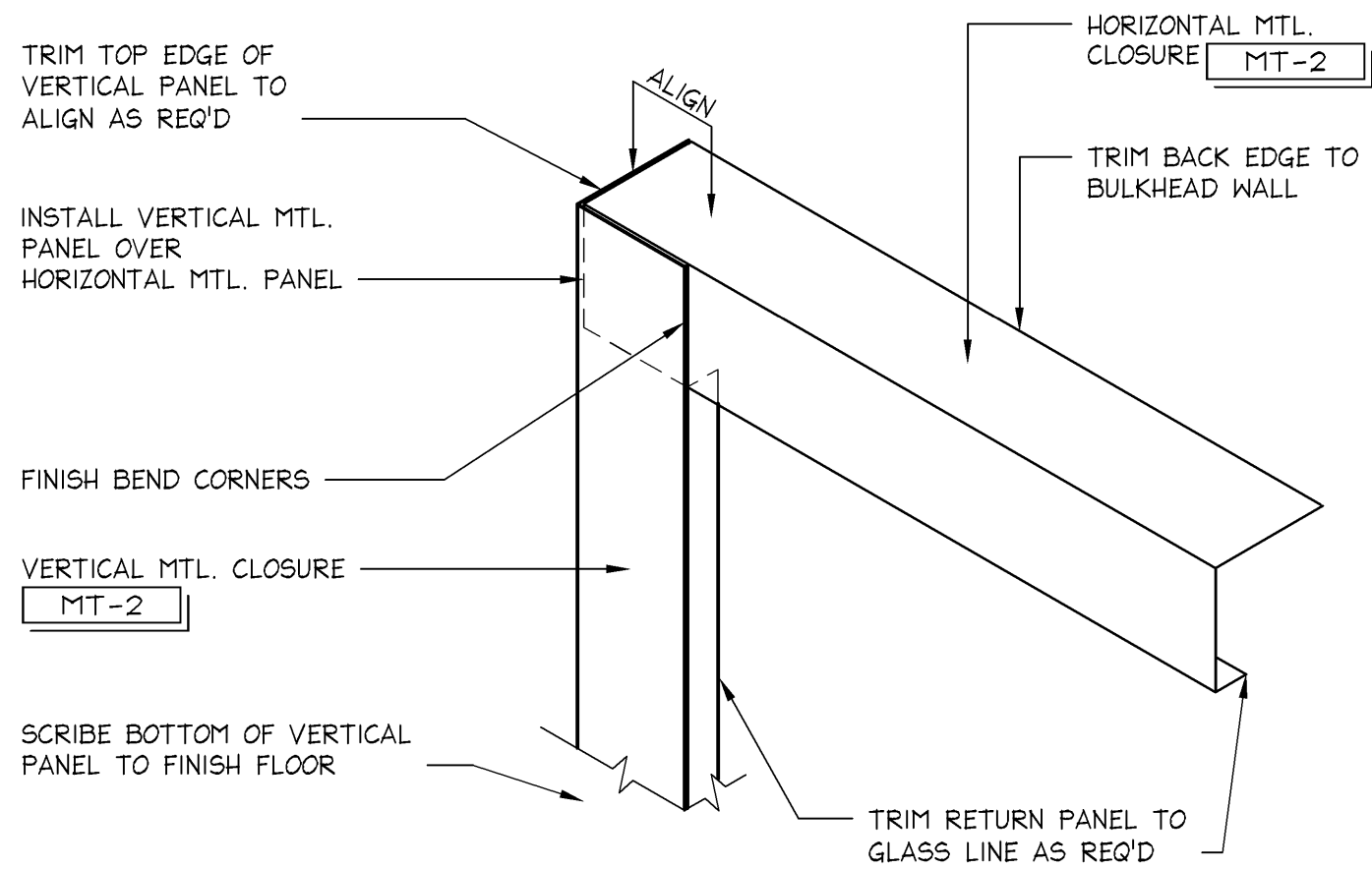

METAL CLOSURE @ CANOPY

3/4" = 1'-0"
C
06.29.09

STOREFRONT PLAN & ELEVATION

1/2" = 1'-0"
42E-A081-A08-ELEV
E
12.06.10

MOODY·NOLAN
responsive architecture
300 Spruce Street Phone: (614) 461-4664
Suite 300 Fax: (614) 280-8861
Columbus, Ohio 43215 www.moodynolan.com

Limited brands
LIMITED STORE PLANNING, INC.
d/b/a STORE DESIGN & CONSTRUCTION
Three Limited Parkway • Columbus, Ohio 43230
Telephone: 614.415.7000 • Fax: 614.415.7349

THESE DRAWINGS AND SPECIFICATIONS ARE THE PROPERTY OF LIMITED BRANDS, INC. AND SHALL NOT BE REPRODUCED OR TRANSMITTED IN ANY FORM OR BY ANY MEANS, ELECTRONIC OR MECHANICAL, INCLUDING PHOTOCOPYING, RECORDING, OR BY ANY INFORMATION STORAGE AND RETRIEVAL SYSTEM, WITHOUT THE WRITTEN PERMISSION OF LIMITED BRANDS, INC. ANY UNAUTHORIZED REPRODUCTION OR TRANSMISSION OF THESE DRAWINGS AND SPECIFICATIONS SHALL BE MADE WITHOUT THE WRITTEN PERMISSION OF LIMITED BRANDS, INC. THESE DRAWINGS AND SPECIFICATIONS ARE THE PROPERTY OF LIMITED BRANDS, INC. AND SHALL NOT BE REPRODUCED OR TRANSMITTED IN ANY FORM OR BY ANY MEANS, ELECTRONIC OR MECHANICAL, INCLUDING PHOTOCOPYING, RECORDING, OR BY ANY INFORMATION STORAGE AND RETRIEVAL SYSTEM, WITHOUT THE WRITTEN PERMISSION OF LIMITED BRANDS, INC. ANY UNAUTHORIZED REPRODUCTION OR TRANSMISSION OF THESE DRAWINGS AND SPECIFICATIONS SHALL BE MADE WITHOUT THE WRITTEN PERMISSION OF LIMITED BRANDS, INC. THESE DRAWINGS AND SPECIFICATIONS ARE THE PROPERTY OF LIMITED BRANDS, INC. AND SHALL NOT BE REPRODUCED OR TRANSMITTED IN ANY FORM OR BY ANY MEANS, ELECTRONIC OR MECHANICAL, INCLUDING PHOTOCOPYING, RECORDING, OR BY ANY INFORMATION STORAGE AND RETRIEVAL SYSTEM, WITHOUT THE WRITTEN PERMISSION OF LIMITED BRANDS, INC. ANY UNAUTHORIZED REPRODUCTION OR TRANSMISSION OF THESE DRAWINGS AND SPECIFICATIONS SHALL BE MADE WITHOUT THE WRITTEN PERMISSION OF LIMITED BRANDS, INC.

PROJECT INFORMATION:
024200396
BATH & BODY WORKS
MEMORIAL CITY MALL
303 MEMORIAL CITY WAY
SUITE 735
HOUSTON, TX 77024
SCOPE: RELO DIVN / NEW / PACKAGE:
DESIGN TYPE: EASTON-C GENERATION:
LSRAC PROJECT #: 60585 A/E PROJECT #:
14159
13643

REVISIONS:
REQUIRED BY: DATE:
ELITE CONSTRUCTION GROUP
LAKE JACKSON, TX
PHONE: 979-285-0712
NOTE: THESE PRINTS HAVE BEEN
REPRODUCED BY 50 PERCENT SCALE
WILL BE 50 PERCENT OF WHAT IS
NOTED ON PLANS.

DATE ISSUED: 04/11/2014
DESIGNED BY: SF
DRAWN BY: TSG
CHECKED BY: TBD

STOREFRONT
PLAN &
ELEVATION

DRAWING NUMBER:
A08.1